

# NOTICE DE MONTAGE

## ASSEMBLY INSTRUCTIONS

**SAUT DE LOUP**

**ALUMINUM DOUBLE ACCESS  
PLATFORM TILT 45°**

**EDALU 45 EVO**

NMU 092 - V01 - 07/2024 - FR/GB



## CONFIGURATION DOUBLE ACCÈS / DOUBLE ACCESS CONFIGURATION

### 1 - Assemblage de l'escalier Staircase assembly

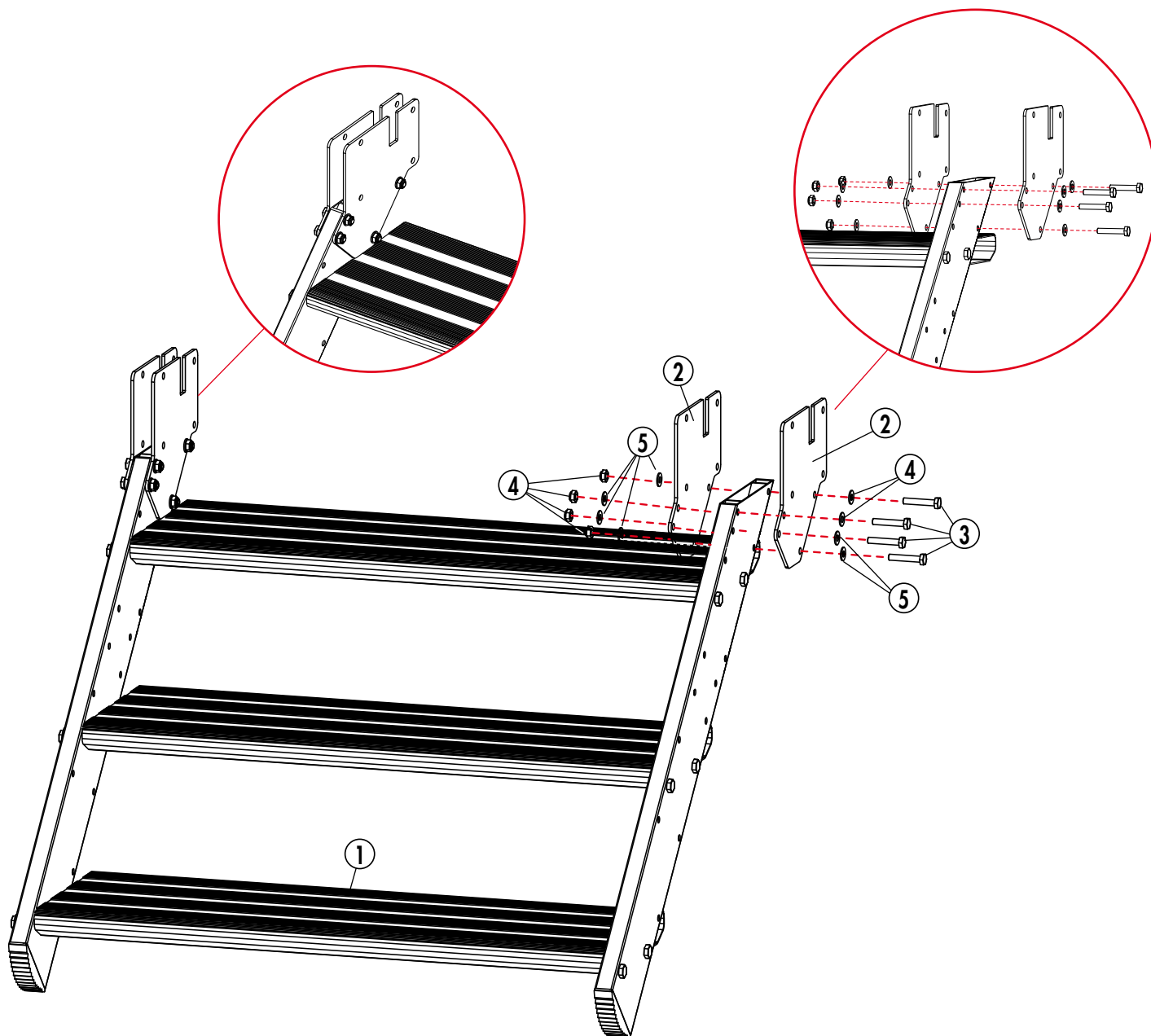

Référence Reference	Désignation Designation	Repère Nr.	Qté Qty
	Escalier / Staircase	1	1
A700120130	Méplat liaison palier/escalier / Landing/staircase flat connection	2	4
A710130045	Vis H Zn M8 x 45 / M8 x 45 H Zn screw	3	8
A710710008	Écrou frein Zn M8 / M8 Zn brake nut	4	8
A710770818	Rondelle plate Zn M8 x 18 / M8 x 18 Zn washer	5	16

## 2 - Montage des pieds Feet mounting

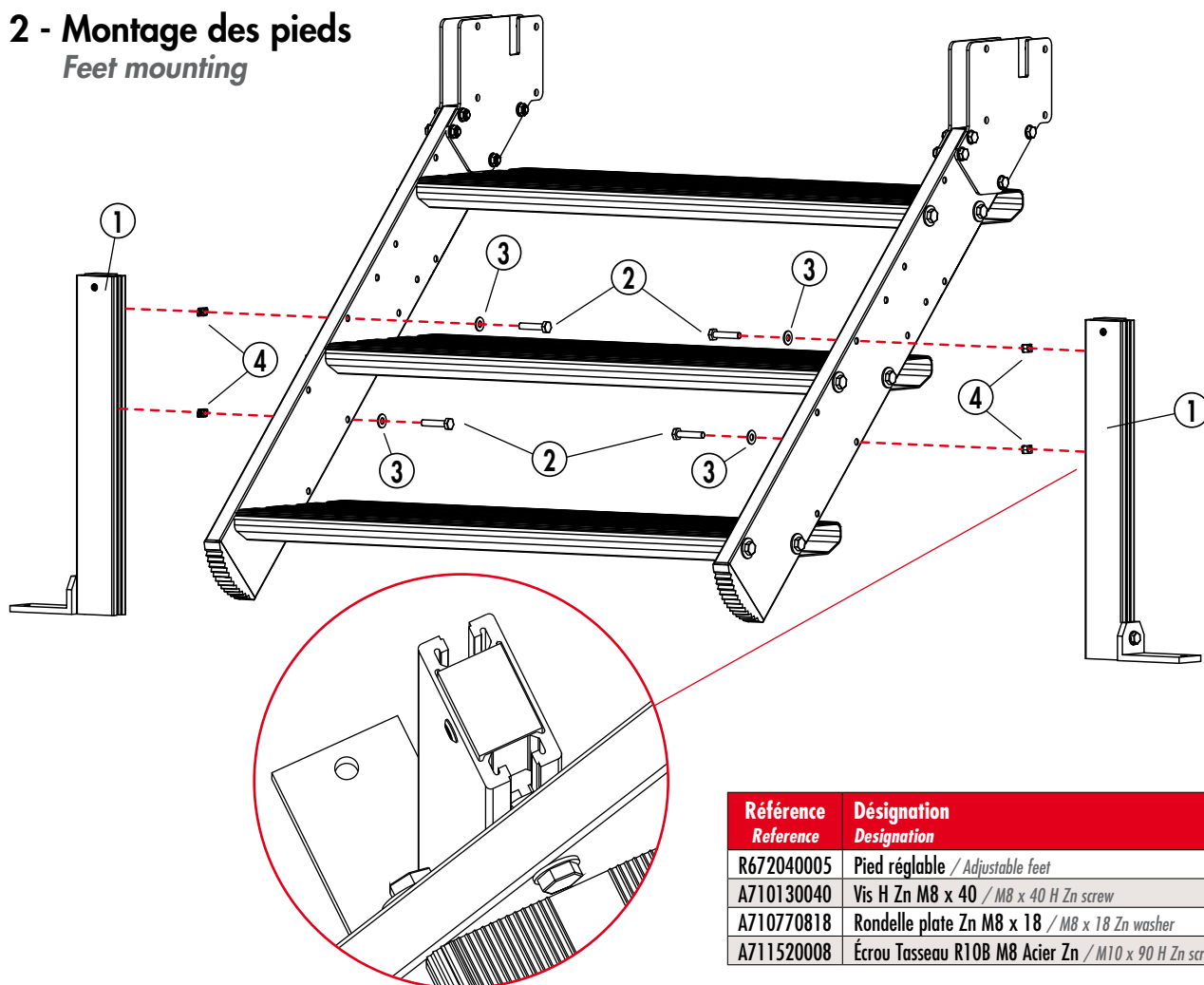

Référence Reference	Désignation Designation	Repère Nr.	Qté Qty
R672040005	Pied réglable / Adjustable feet	1	2
A710130040	Vis H Zn M8 x 40 / M8 x 40 H Zn screw	2	4
A710770818	Rondelle plate Zn M8 x 18 / M8 x 18 Zn washer	3	4
A711520008	Écrou Tasseau R10B M8 Acier Zn / M10 x 90 H Zn screw	4	4

## Escalier monté Mounted staircase

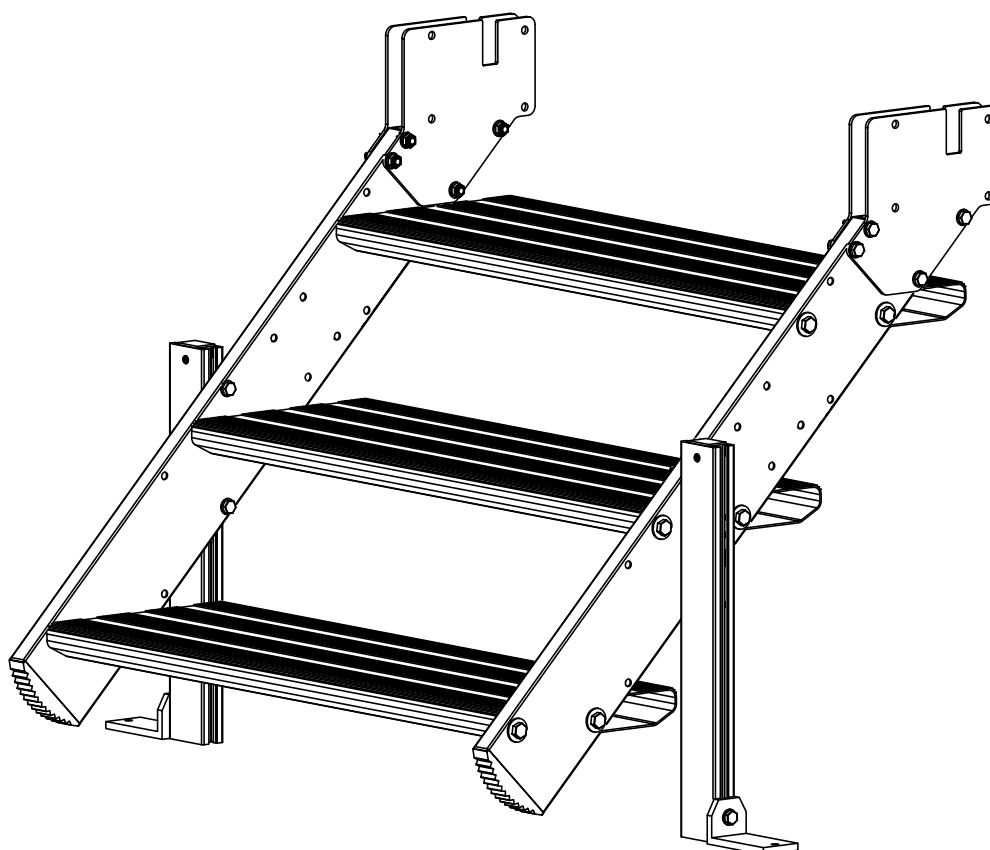

### 3 - Montage de la plateforme sur les escaliers platform mounting on the staircases

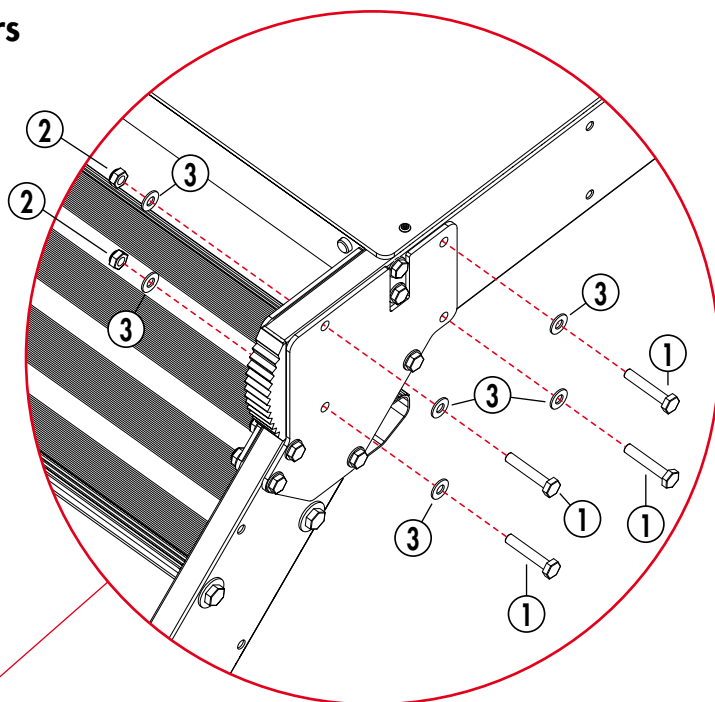
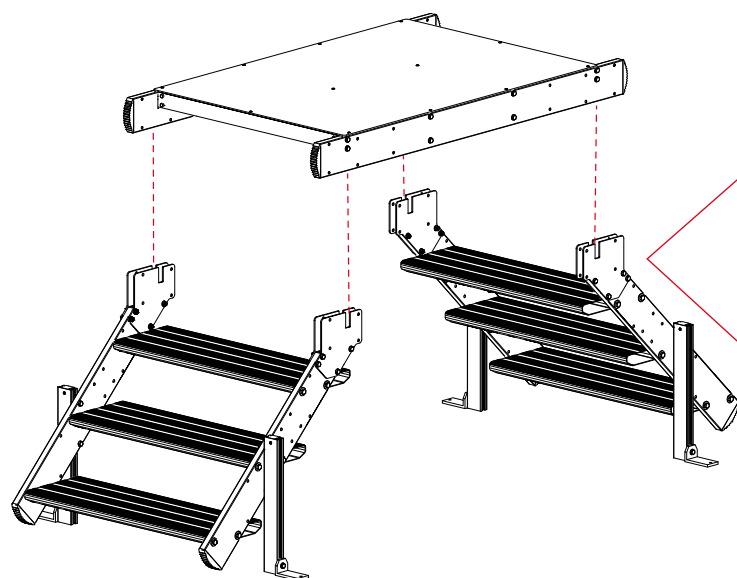

Vue du dessus/Top view

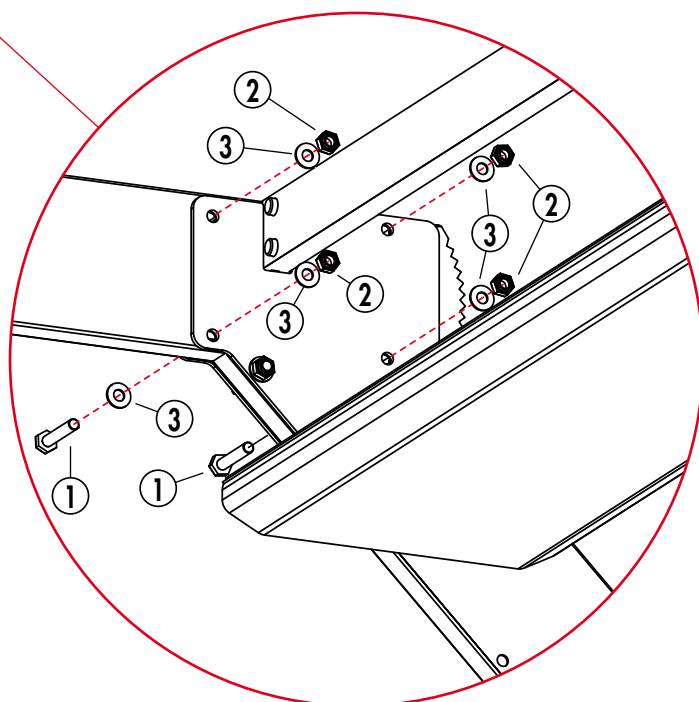

Vue du dessous/Bottom view

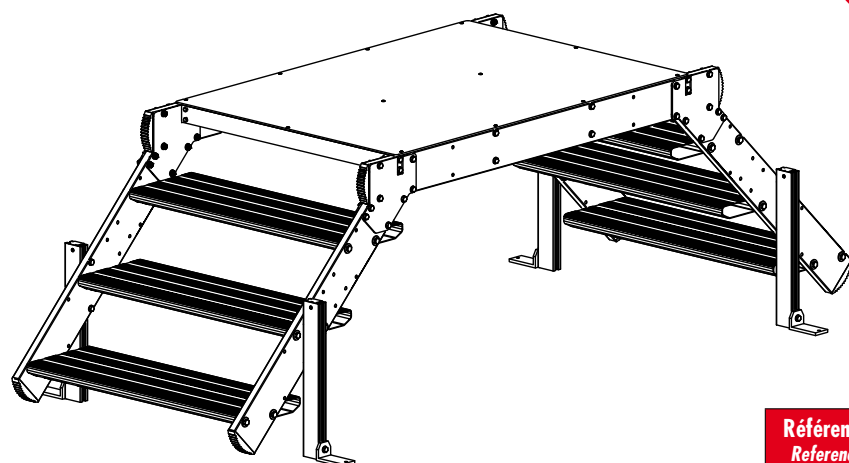

Escaliers et plateforme montés  
 Mounted staircases and platform

Référence Reference	Désignation Designation	Repère Nr.	Qté Qty
A710130045	Vis H Zn M8 x 45 / M8 x 45 H Zn screw	1	16
A710710008	Écrou frein Zn M8 / M8 Zn brake nut	2	16
A710770818	Rondelle plate Zn M8 x 18 / M8 x 18 Zn washer	3	32

## 4 - Montage des plots sur les pieds réglables (si option plots fournie) Counterweights mounting on adjustable feet (if optional Counterweights supplied)

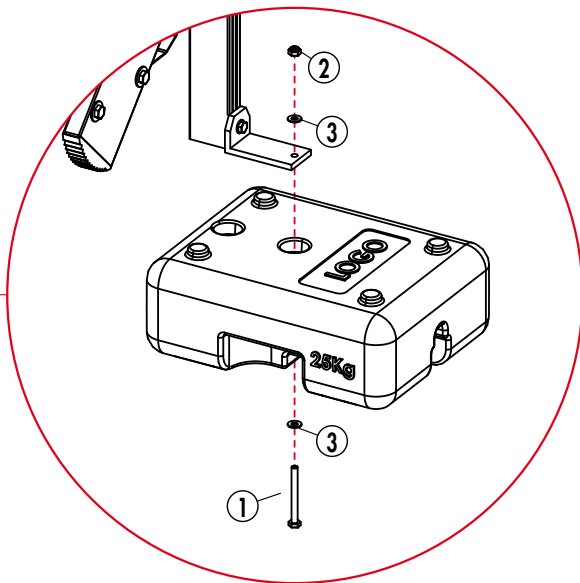
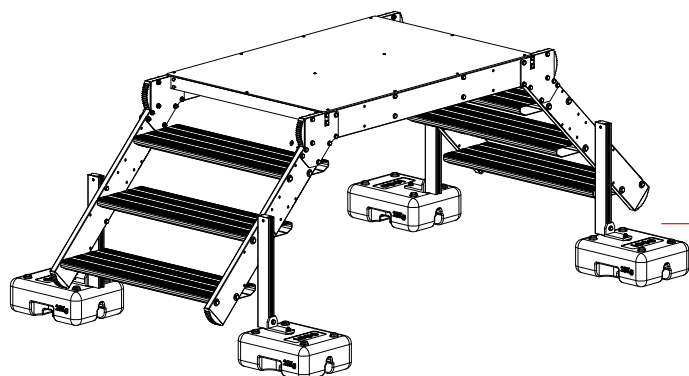

Référence Reference	Désignation Designation	Repère Nr.	Qté Qty
A710130080	Vis H Zn M8 x 80 / M8 x 80 H Zn screw	1	4
A710710008	Écrou frein Zn M8 / M8 Zn brake nut	2	4
A710770818	Rondelle plate Zn M8 x 18 / M8 x 18 Zn washer	3	8

## 5 - Montage des garde-corps Guardrails mounting

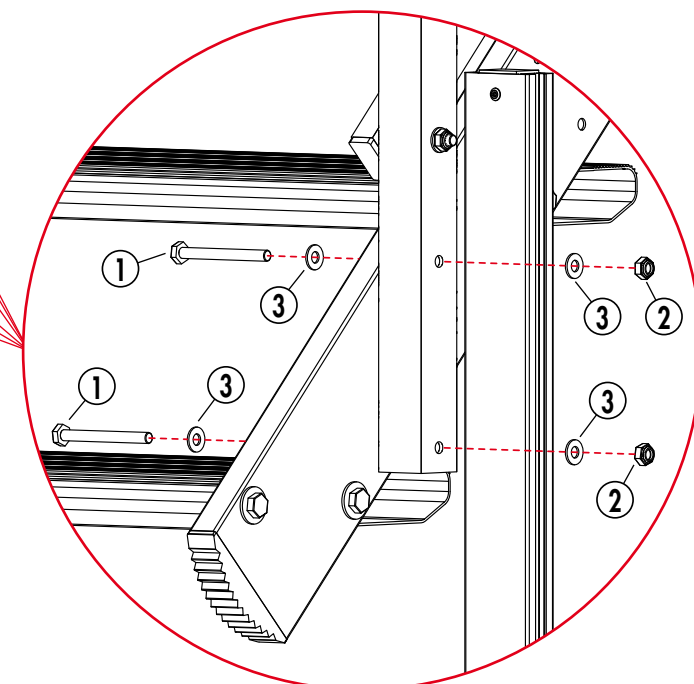
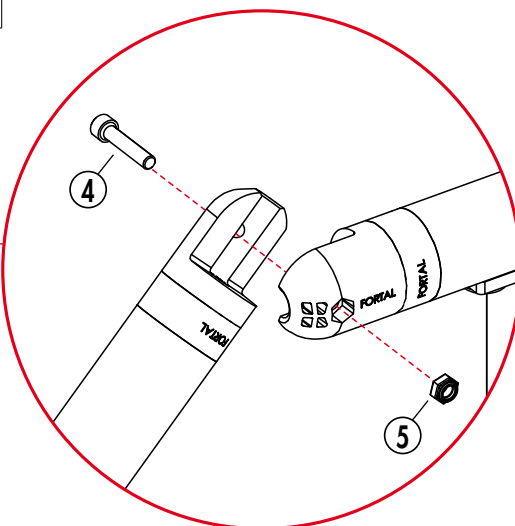
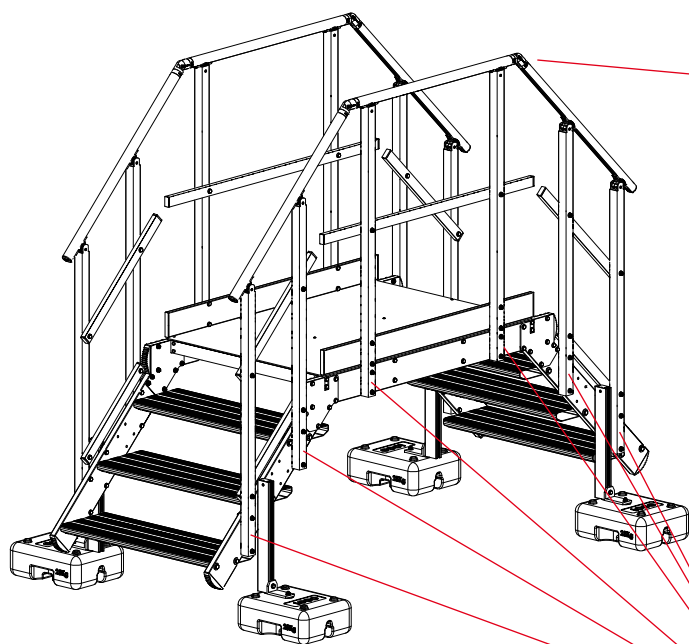

Référence Reference	Désignation Designation	Repère Nr.	Qté Qty
A710130080	Vis H Zn M8 x 80 / M8 x 80 H Zn screw	1	24
A710710008	Écrou frein Zn M8 / M8 Zn brake nut	2	24
A710770818	Rondelle plate Zn M8 x 18 / M8 x 18 Zn washer	3	48
A710610030	Vis CHC Zn M6 x 30 / M6 x 30 CHC Zn screw	4	4
A710710006	Écrou frein Zn M6 / M6 Zn brake nut	5	4

**CONFIGURATION ACCÈS SIMPLE / SINGLE ACCESS CONFIGURATION**

**KIT DE FIXATION MURALE POUR ESCALIER DROIT / WALL-MOUNTING KIT FOR STRAIGHT STAIRCASE**

**1 - Montage du kit sur l'escalier**  
*Kit mounting on the staircase*

- ① Principe de montage identique à la page 4  
*Mounting principle identical to page 4*
- ② Fixer l'ensemble au mur avant le montage des garde-corps (visserie non fournie)  
*Fix the assembled unit to the wall before fixing the guardrails (screws not supplied)*

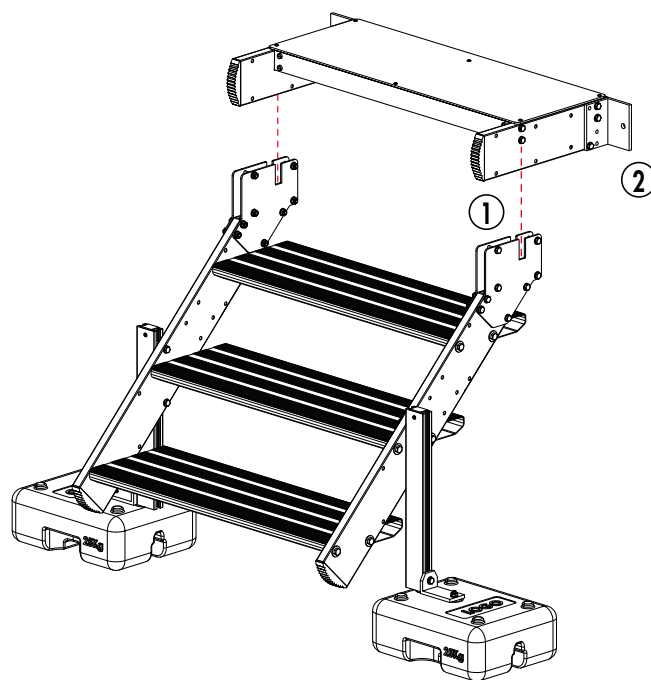

**2 - Montage des garde-corps**  
*Guardrails mounting*

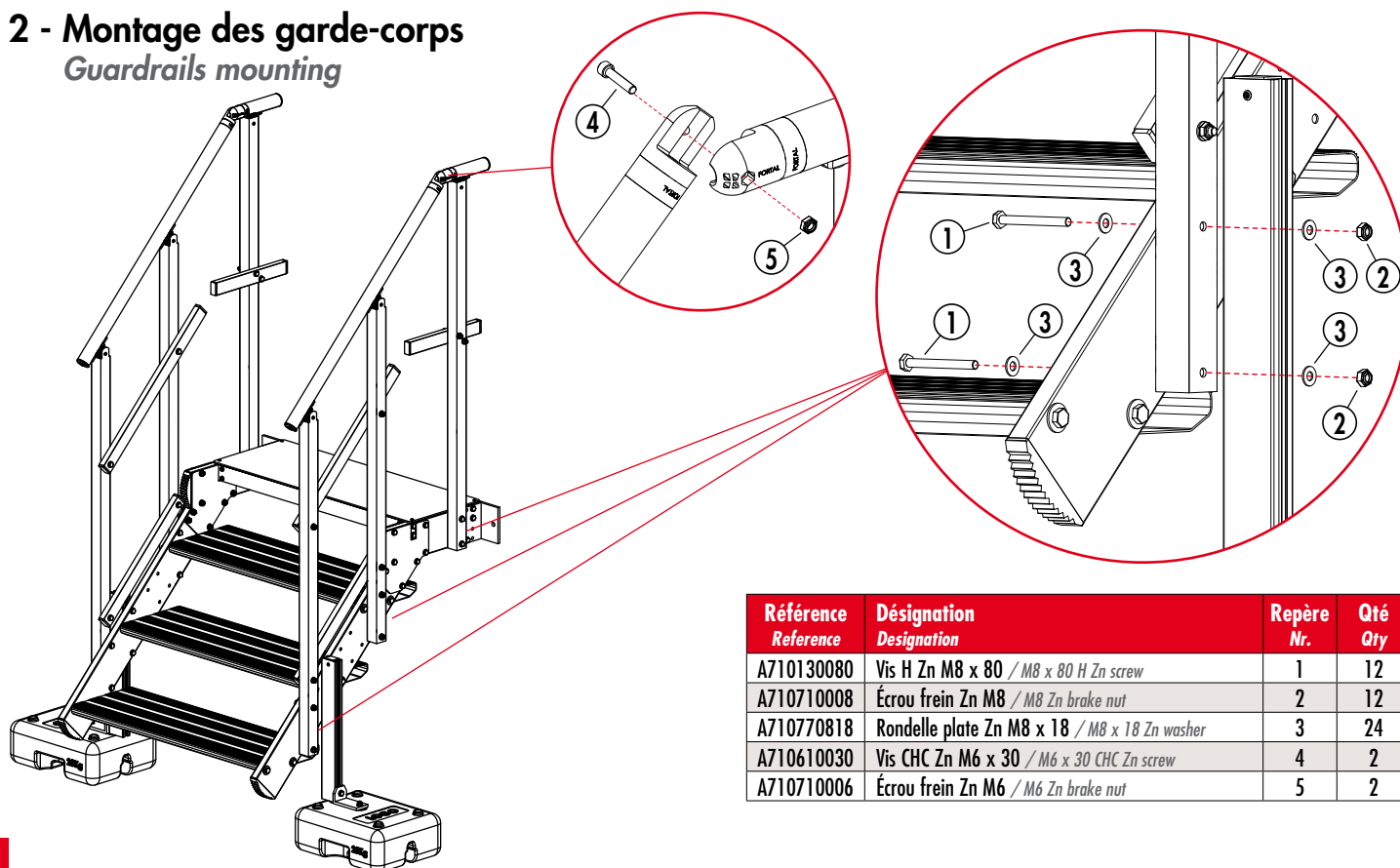

Référence Reference	Désignation Designation	Repère Nr.	Qté Qty
A710130080	Vis H Zn M8 x 80 / M8 x 80 H Zn screw	1	12
A710710008	Écrou frein Zn M8 / M8 Zn brake nut	2	12
A710770818	Rondelle plate Zn M8 x 18 / M8 x 18 Zn washer	3	24
A710610030	Vis CHC Zn M6 x 30 / M6 x 30 CHC Zn screw	4	2
A710710006	Écrou frein Zn M6 / M6 Zn brake nut	5	2

**KIT DE FIXATION MURALE POUR ESCALIER À PALIER / WALL-MOUNTING KIT FOR STAIRCASE WITH LANDING**

**1 - Montage du kit sur l'escalier**  
*Kit mounting on the staircase*

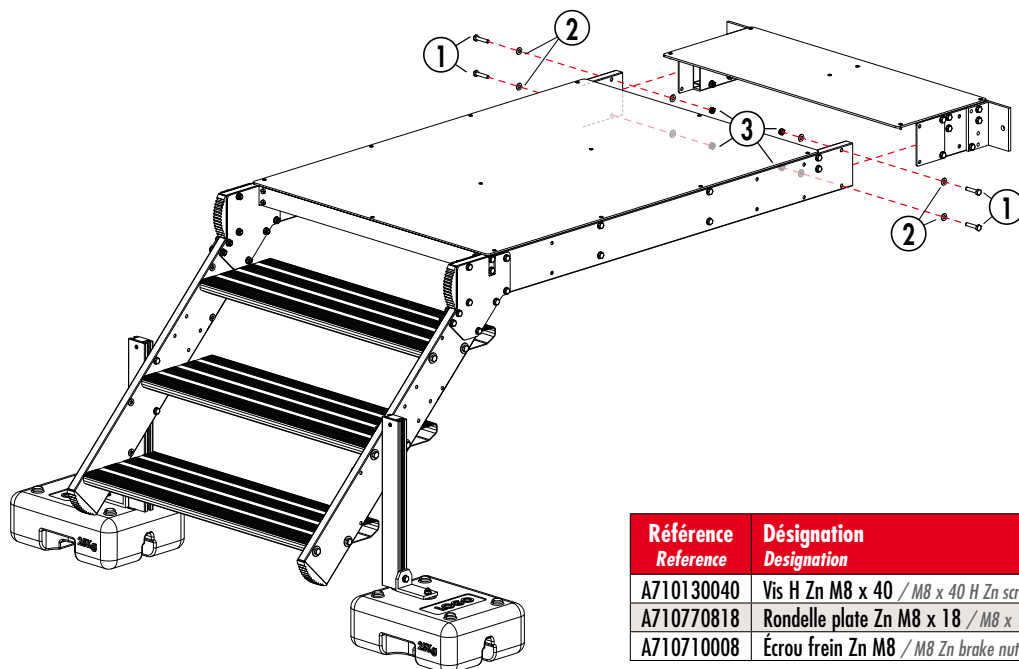

Référence Reference	Désignation Designation	Repère Nr.	Qté Qty
A710130040	Vis H Zn M8 x 40 / M8 x 40 H Zn screw	1	4
A710770818	Rondelle plate Zn M8 x 18 / M8 x 18 Zn washer	2	8
A710710008	Écrou frein Zn M8 / M8 Zn brake nut	3	4

**2 - Montage des garde-corps**  
*Guardrails mounting*

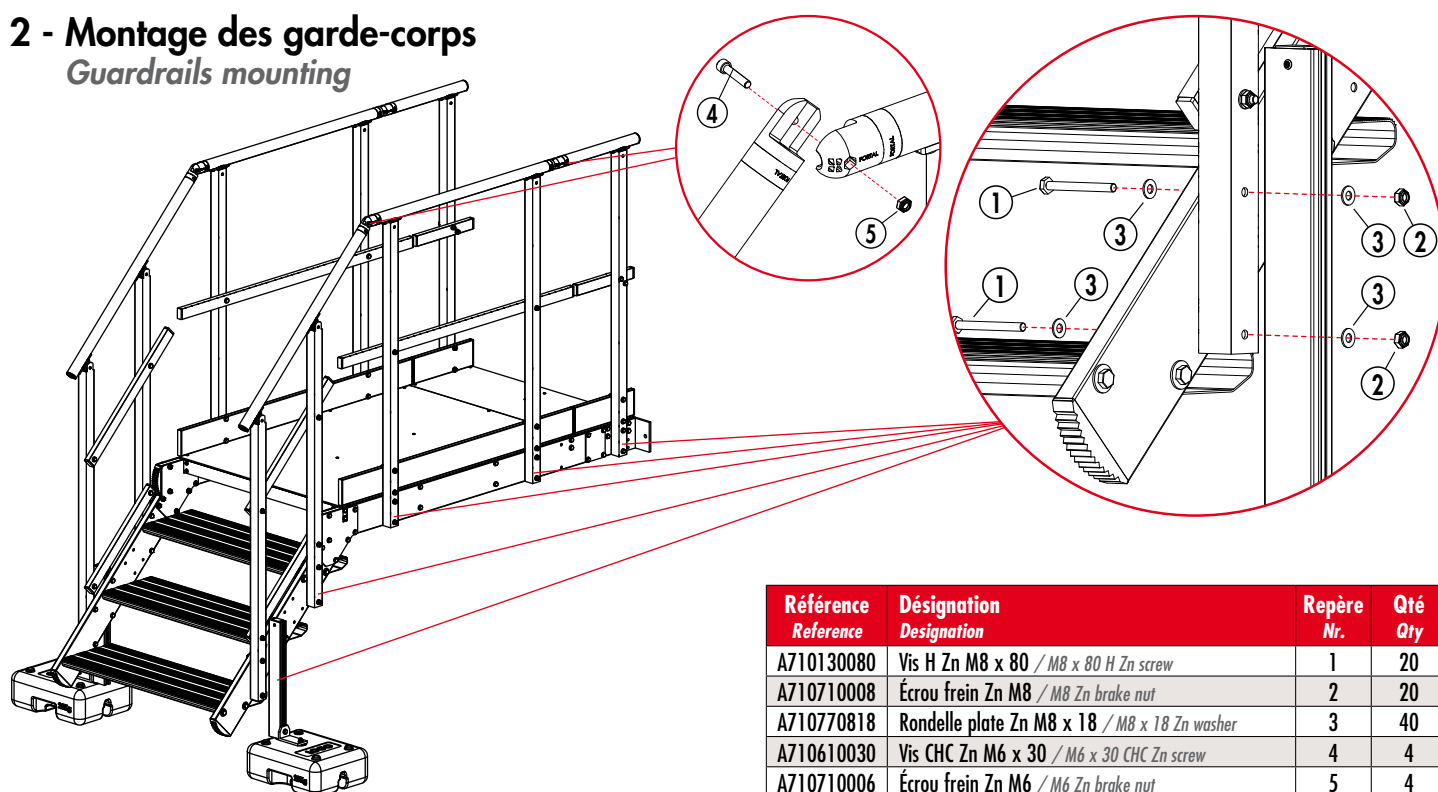

Référence Reference	Désignation Designation	Repère Nr.	Qté Qty
A710130080	Vis H Zn M8 x 80 / M8 x 80 H Zn screw	1	20
A710710008	Écrou frein Zn M8 / M8 Zn brake nut	2	20
A710770818	Rondelle plate Zn M8 x 18 / M8 x 18 Zn washer	3	40
A710610030	Vis CHC Zn M6 x 30 / M6 x 30 CHC Zn screw	4	4
A710710006	Écrou frein Zn M6 / M6 Zn brake nut	5	4

**ALU LOCK**